

| CODE | Height (mm) | Width (mm) | Depth (mm) | Centres (C) (mm) | Bracket / Connection Centres (S) (mm) | Bracket Centres (L) (mm) | Weight (Kg) | Water capacity (ltrs) | Power (watts) |
|---------------|-------------|------------|------------|------------------|---------------------------------------|--------------------------|-------------|-----------------------|---------------|
| Innovate 1008 | 1000 | 245 | 82 | 245 | 960 | 125 | 11.5 | 4.7 | 907 |
| Innovate 1508 | 1500 | 245 | 82 | 245 | 1460 | 125 | 16.6 | 6.9 | 1329 |
| Innovate 1808 | 1800 | 245 | 82 | 245 | 1760 | 125 | 19.7 | 8.2 | 1582 |
| Innovate 2008 | 2000 | 245 | 82 | 245 | 1960 | 125 | 21.7 | 9.0 | 1751 |
| Innovate 1012 | 1000 | 345 | 82 | 345 | 960 | 225 | 16.4 | 6.0 | 1300 |
| Innovate 1512 | 1500 | 345 | 82 | 345 | 1460 | 225 | 23.6 | 8.6 | 1906 |
| Innovate 1812 | 1800 | 345 | 82 | 345 | 1760 | 225 | 28.1 | 10.2 | 2268 |
| Innovate 2012 | 2000 | 345 | 82 | 345 | 1960 | 225 | 30.9 | 11.3 | 2511 |
| Innovate 1016 | 1000 | 445 | 82 | 445 | 960 | 325 | 21.2 | 7.2 | 1693 |
| Innovate 1516 | 1500 | 445 | 82 | 445 | 1460 | 325 | 30.7 | 10.4 | 2481 |
| Innovate 1816 | 1800 | 445 | 82 | 445 | 1760 | 325 | 36.4 | 12.3 | 2955 |
| Innovate 2016 | 2000 | 445 | 82 | 445 | 1960 | 325 | 40.2 | 13.6 | 3270 |
| Innovate 1020 | 1000 | 545 | 82 | 545 | 960 | 425 | 26.1 | 8.4 | 2085 |
| Innovate 1520 | 1500 | 545 | 82 | 545 | 1460 | 425 | 37.8 | 12.2 | 3057 |
| Innovate 1820 | 1800 | 545 | 82 | 545 | 1760 | 425 | 44.7 | 14.4 | 3641 |
| Innovate 2020 | 2000 | 545 | 82 | 545 | 1960 | 425 | 49.4 | 15.9 | 4030 |

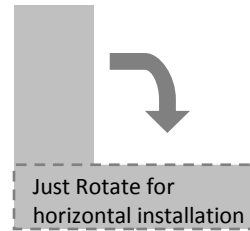

| material | finish | electric version |
|-----------------|----------------|------------------|
| stainless steel | satin polished | not available |

| wall installation | warranty |
|-----------------------|----------|
| vertical / horizontal | 10 years |

max. working pressure: 10 bar
 max. working temperature: 95°C
 all dimensions are in mm.
 connections 1/2"

Innovate Technical Detail : RC/PW/01.11

[Outputs: 90/70/20 Δt 60°C EN442]

[Dimensions in millimetres]

Pipe Centres = Width + valve centres
 ie: Width + 80mm with Standard RadCen Valves
 (PLEASE NOTE: Flow connection = Right hand side)

Please note : Flow diverter must be removed with a screwdriver for horizontal installation

Radiator Centre Ltd : 2 Grand Parade, Polegate, East Sussex, BN26 5HG
 WWW.radiatorcentre.com : info@radiatorcentre.com : Tel 01323 486848 : Fax 01323 486687

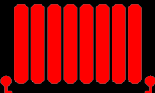

Radiator Centre Ltd : 2 Grand Parade, Polegate, East Sussex, BN26 5HG
WWW.radiatorcentre.com : info@radiatorcentre.com : Tel 01323 486848 : Fax 01323 486687

| CODE | Height (mm) | Width (mm) | Depth (mm) | Centres (C) (mm) | Bracket / Connection Centres (S) (mm) | Bracket Centres (L) (mm) | Weight (Kg) | Water capacity (ltrs) | Power (watts) |
|-----------------|-------------|------------|------------|------------------|---------------------------------------|--------------------------|-------------|-----------------------|---------------|
| FUT061007602109 | 760 | 610 | 82 | 610 | 545 | 375 | 18.8 | 5.9 | 1259 |
| FUT071007602509 | 760 | 710 | 82 | 710 | 546 | 475 | 21.1 | 6.6 | 1452 |
| FUT081007602909 | 760 | 810 | 82 | 810 | 547 | 575 | 23.6 | 7.3 | 1622 |
| FUT091007603309 | 760 | 910 | 82 | 910 | 548 | 675 | 26.1 | 7.9 | 1793 |
| FUT111007604109 | 760 | 1110 | 82 | 1110 | 549 | 875 | 31.1 | 9.2 | 1964 |

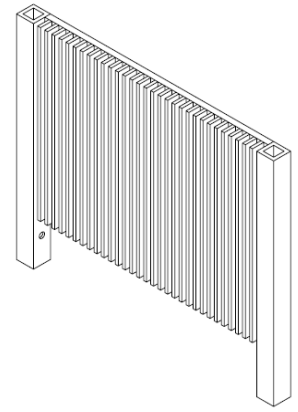
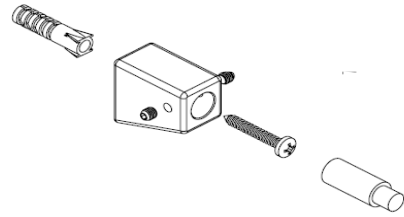
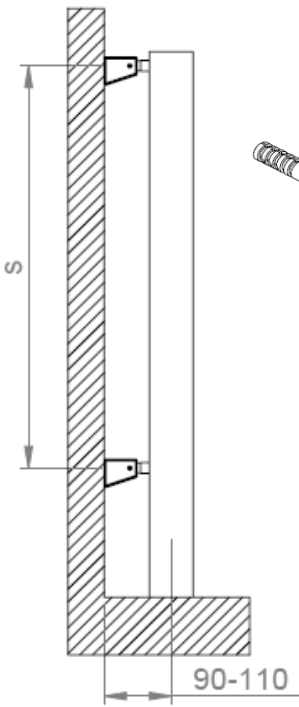
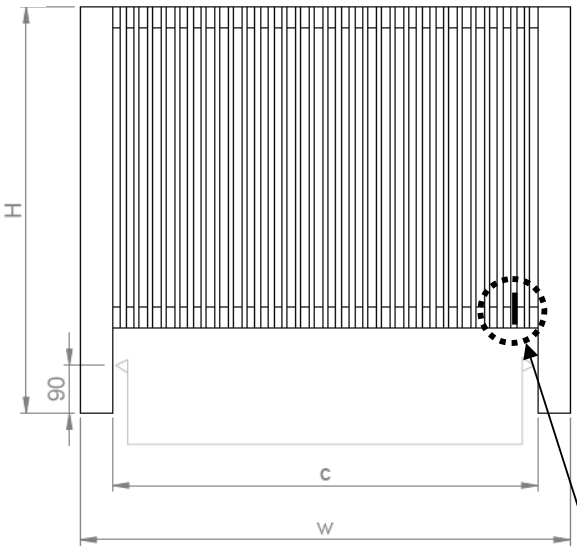
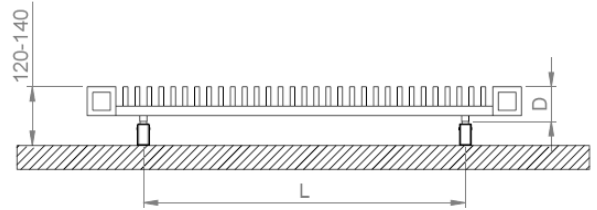

| material | finish | electric version |
|----------|--------|------------------|
|----------|--------|------------------|

stainless steel satin polished not available

| wall installation | warranty |
|-------------------|----------|
|-------------------|----------|

floor standing 10 years

max. working pressure: 10 bar
 max. working temperature: 95°C
 all dimensions are in mm.
 connections 1/2"

Innovate Technical Detail : RC/PW/01.11

[Outputs: 90/70/20 Δt 60°C EN442]

[Dimensions in millimetres]

Pipe Centres = C - valve centres
ie: C - 80mm with Standard RadCen Valves
(PLEASE NOTE: Flow connection = Right hand side)